



**2 Bed  
Bungalow - Semi  
Detached  
located  
in Wellesbourne**

**Guide Price £325,000**



  
**MARGETTS**  
ESTABLISHED 1806



# Ground Floor

Approx. 55.4 sq. metres (596.1 sq. feet)

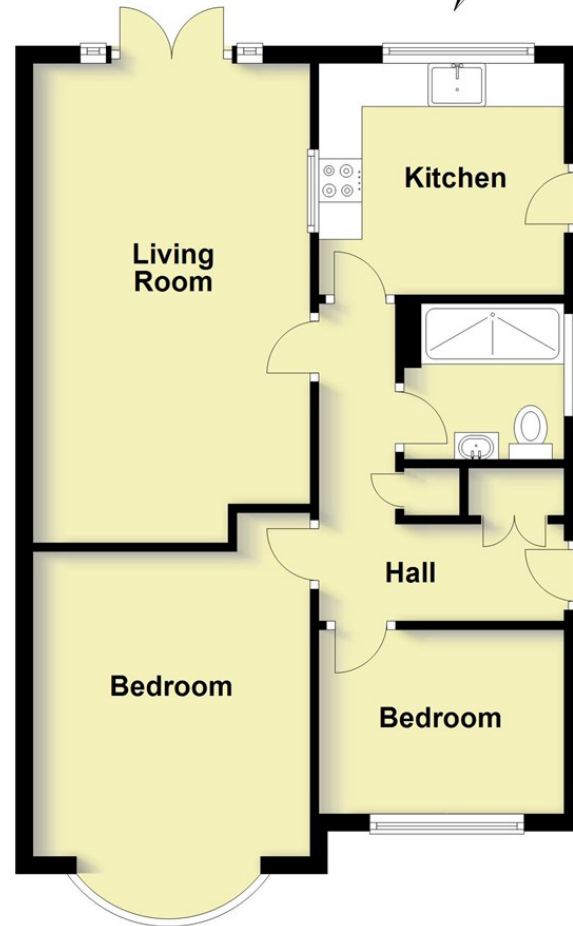

Total area: approx. 55.4 sq. metres (596.1 sq. feet)

This plan is for illustration purposes only and should not be relied upon as a statement of fact

Energy Efficiency Rating		
	Current	Potential
Very energy efficient - lower running costs		
(92 plus) <b>A</b>		
(81-91) <b>B</b>		
(69-80) <b>C</b>		
(55-68) <b>D</b>		
(39-54) <b>E</b>		
(21-38) <b>F</b>		
(1-20) <b>G</b>		
Not energy efficient - higher running costs		
EU Directive 2002/91/EC		
England & Wales		

## DIRECTIONS

## CONTACT

12 High Street  
Warwick  
Warwickshire  
CV34 4AP

E: [sales@margetts.co.uk](mailto:sales@margetts.co.uk)  
T: 01926 496262  
[www.margetts.co.uk](http://www.margetts.co.uk)

